

# Weld X Flange Connection

## Series US Weld X Flange Carbon Steel

- Weld X Flange Ball Valve
- ANSI Class 300 (740 PSI WP)
- 2" Through 4"
- Multi-Seal Seats
- True Full Port for Hot Tap Service
- Heat Dissipating Fins for Protection of Seats and Seals During Welding
- Rugged Stainless Steel Lock Plate
- Heavy Duty Forged Steel Components
- Solid Balls for Reduction of Turbulence and Pressure Drop
- Stainless Steel Stem Standard

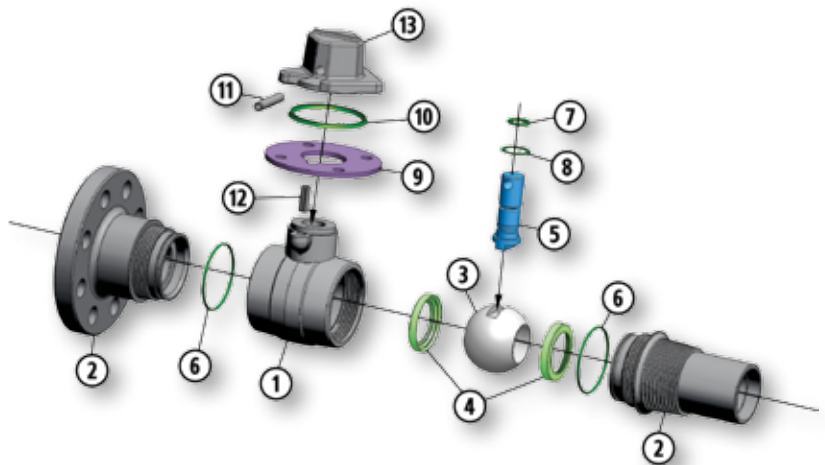

### Material Description

| ITEM | PART NAME             | MATERIAL (STANDARD)                 |
|------|-----------------------|-------------------------------------|
| 1    | Body                  | ASTM A105                           |
| 2    | Adapter               | ASTM A105                           |
| 3    | Ball                  | Carbon Steel - Nickel Chrome Plated |
| 4    | Seats                 | Nylon                               |
| 5    | Stem                  | 316 Stainless Steel                 |
| 6    | Body O-Ring           | Buna-N                              |
| 7    | Stem O-Ring           | Buna-N                              |
| 8    | Stem Seal             | TFE                                 |
| 9    | Lock Plate            | Stainless Steel                     |
| 10   | Weather Seal          | Polyethylene                        |
| 11   | Roll Pin              | Stainless Steel                     |
| 12   | Stop Pin              | Stainless Steel                     |
| 13   | Drive Nut - 2" Square | Ductile Iron                        |

\* Note: Valve is seal welded and is not field repairable.

### Dimensional Data

| SIZE    | CATALOG    | PORT/A | B     | C   | D    | E    | F | G   | LBS. | Cv  |
|---------|------------|--------|-------|-----|------|------|---|-----|------|-----|
| 2x1.5x2 | 2R-US33-WF | 1.5    | 10.15 | 5.9 | 5    | 6.50 | 2 | 4.5 | 23   | 148 |
| 2x2x2   | 2F-US33-WF | 2      | 10.2  | 5.9 | 5.50 | 6.50 | 2 | 4.5 | 28   | -   |
| 3x3x3   | 3F-US33-WF | 3      | 11.5  | 5.9 | 6.75 | 8.25 | 2 | 4.5 | 56   | -   |
| 4x3x4   | 4R-US33-WF | 3      | 12.4  | 6.4 | 6.75 | 10   | 2 | 4.5 | 70   | 662 |
| 4x4x4   | 4F-US33-WF | 4      | 12.4  | 6.4 | 7.50 | 10   | 2 | 4.5 | 91   | -   |

