

# PARTS LIST - 2" x 1" Port Valves

2" x 1"

Includes: 2" x 1" RF Flanged CL 150 - 600

Port

Item	Description	Material	Part Number
1	Body - Dual Port 2" x 1" CL 150 RF Flanged (FG-69) <sup>†</sup> 2" x 1" CL 300 RF Flanged (FG-70) <sup>†</sup> 2" x 1" CL 600 RF Flanged (FG-71) <sup>†</sup>	Carbon Steel (A216 Gr. WCB)	102-096-01 102-097-01 102-098-01
2	Body Seal Nitrile Viton	Nitrile Viton	101-059-01 101-059-02
3	Throttle Plate 100% Capacity Flowgrid 75% Capacity Flowgrid 50% Capacity Flowgrid 35% Capacity Flowgrid	17-4PHSST 17-4PHSST 17-4PHSST 17-4PHSST	101-055-01 101-083-01 101-063-01 101-061-01
3a	100% Capacity Drilled Hole 75% Capacity Drilled Hole 50% Capacity Drilled Hole 35% Capacity Drilled Hole	A 515 w/ENC Coating A 515 w/ENC Coating A 515 w/ENC Coating A 515 w/ENC Coating	101-084-01 101-085-01 101-086-01 101-087-01
4	Diaphragm 75 Durometer 60 Durometer 80 Durometer Hi-ACN 80 Durometer Lo-ACN Viton	Nitrile/Nylon Nitrile/Nylon Nitrile/Nylon Nitrile/Nylon Viton/Nylon	101-056-01 101-056-02 101-056-03 101-056-04 101-056-05
5	Main Spring Standard Low Differential	301 Stainless Steel	101-057-01 101-074-01
6	Spring Case with Diaphragm Guide	Carbon Steel (A216 Gr. WCB)	101-058-01
7	Cap Screw (9/16UNC x 2.25 Lg)	SAE Grade 8	030-007-01

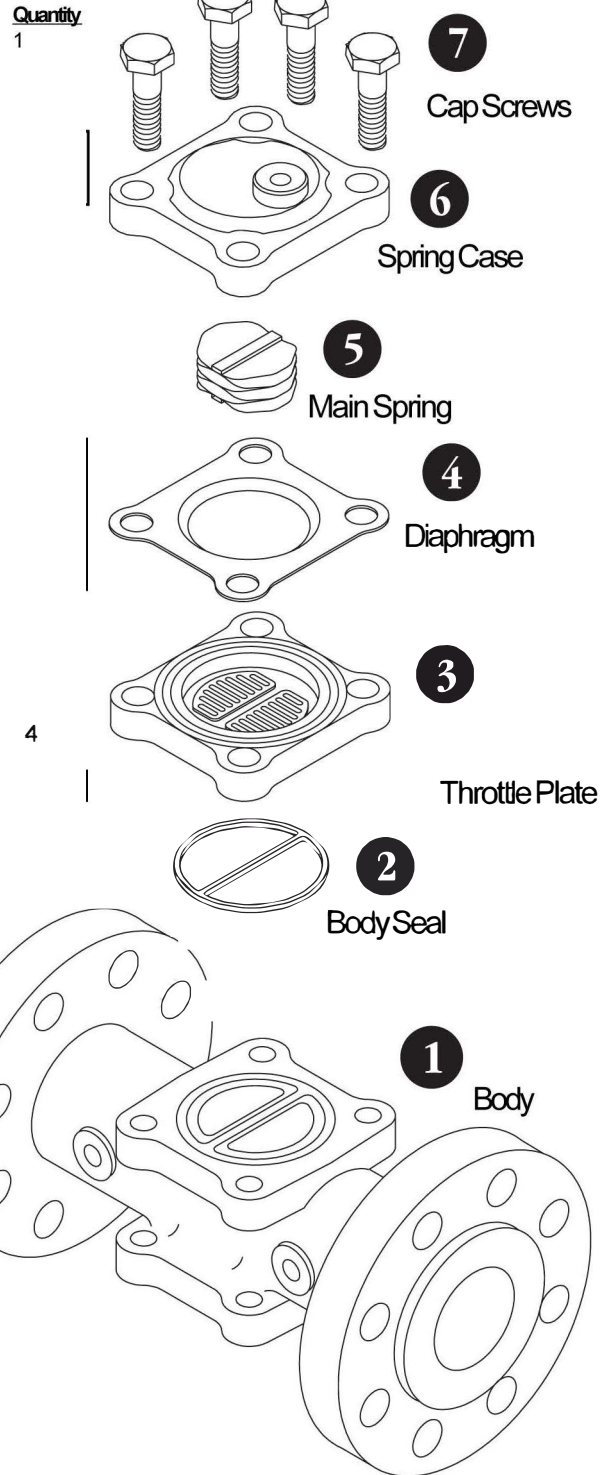

[ **Boxed items indicate recommended spare parts**

<sup>†</sup> (FG-\*) Indicates stock number for the Flowgrid Valve Assembly associated with each body

**3a** Drilled Hole Throttle Plate

