

# PARTS LIST - 2" FLOWGRID® 250 VALVES

Includes: 2" NPT, 2" RF Flanged CL 150 D.I., FF Flanged CL 150 D.I.  
 Ductile Iron/Aluminum Construction Maximum Inlet Pressure 250 PSI

**2"**  
**FLOWGRID®**  
**250**

Item	Description	Material	Part Number	Quantity
Item	Description	Material	Part Number	Quantity
1	Body - Single Port	A 395 Ductile Iron		1
	2" NPT End Connection D.I. (FG-82)		122-002-01	
1a	2" CL 150 RF Flanged D.I. (FG-83)		122-009-01	
	2" CL 150 Flat Face Flanged D.I. (FG-84)			122-010-01
2	Body Seal			1
	Nitrile	Nitrile	102-016-01	
	Viton®	Viton®	102-016-02	
3	Gasket**			1
	Nitrile	Nitrile	122-005-01	
	Viton®	Viton®	122-005-02	
4	Restricting Plate**	Steel (Zinc Plated)		1
	75% Capacity		122-006-01	
	50% Capacity		122-007-01	
	35% Capacity		122-008-01	
5	Throttle Plate	356 - T6 Hard Anodized Aluminum	122-003-01	
6	Diaphragm			1
	60 Durometer (Std)	Nitrile / Nylon	102-053-02	
	75 Durometer	Nitrile / Nylon	102-053-01	
	Viton®	Viton® / Nylon	102-053-05	
7	Main Spring	301 Stainless Steel		1
	Standard		102-014-01	
	Low Differential		102-034-01	
8	Spring Case	356-T6 Aluminum - Alodine	122-004-01	
9	Cap Screw (5/8 - 11 UNC x 2.25 Lg)	SAE Grade 8	030-019-01	4
10	Capacity Tag	Brass	100-014-01	1

### Boxed items indicate recommended spare parts

11	2" Flowgrid 250 Port Rebuild Kit (includes items 2 & 6) (*XX indicate Diaphragm durometer, refer to item 6)	-	122-015-XX*	1
----	---	---	-------------	---

† (FG-\*) Indicates stock number for the Flowgrid Valve Assembly associated with each body

\*\*Reduced capacity: An extra gasket (item 3) and restricting plate (item 4) are required for reduced capacity trim.

®Viton is a registered trademark of E.I. du Pont de Nemours and Company

### 1a Flanged Body

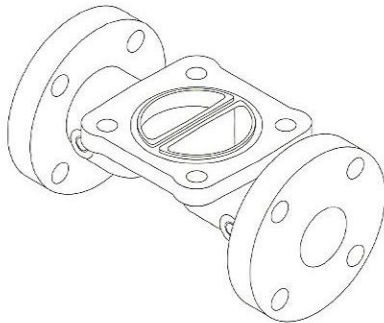

### Optional Reduced Capacity Trim

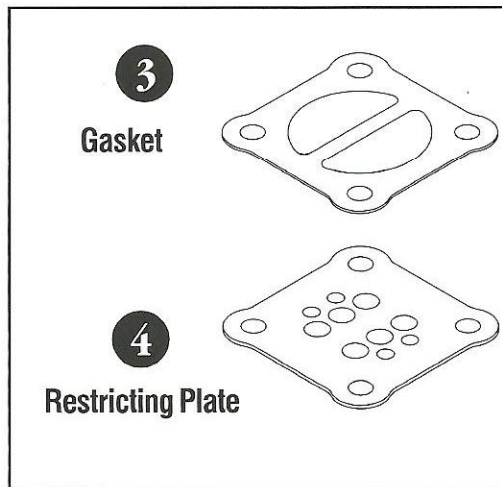

### 9 Cap Screws

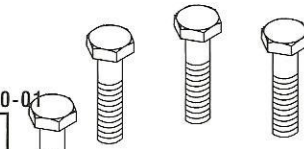

### Capacity Tag 10

### 8 Spring Case

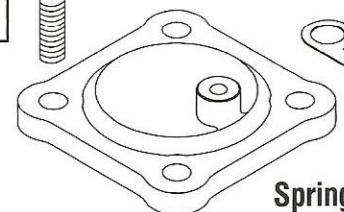

### 7 Main Spring

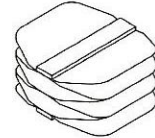

### 6 Diaphragm

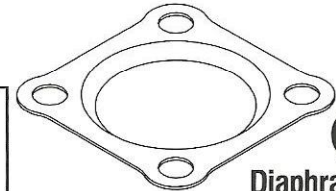

### 5 Throttle Plate

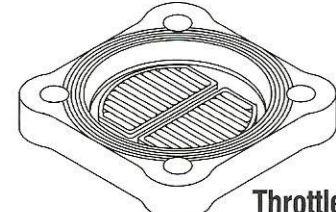

### 2 Body Seal

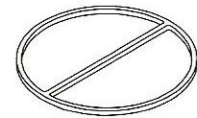

### 1 Body

